

FORM NO. 1.

The following are the Courses and Distances along down Susquehanna River Viz.

- 5 68 E 11 1/2
- 5 83 E 17
- N 87 E 8
- 5 79 E 9
- 5 67 E 18
- 5 49 E 6
- 5 60 E 32
- 5 39 E 32
- 5 35 E 18 \*

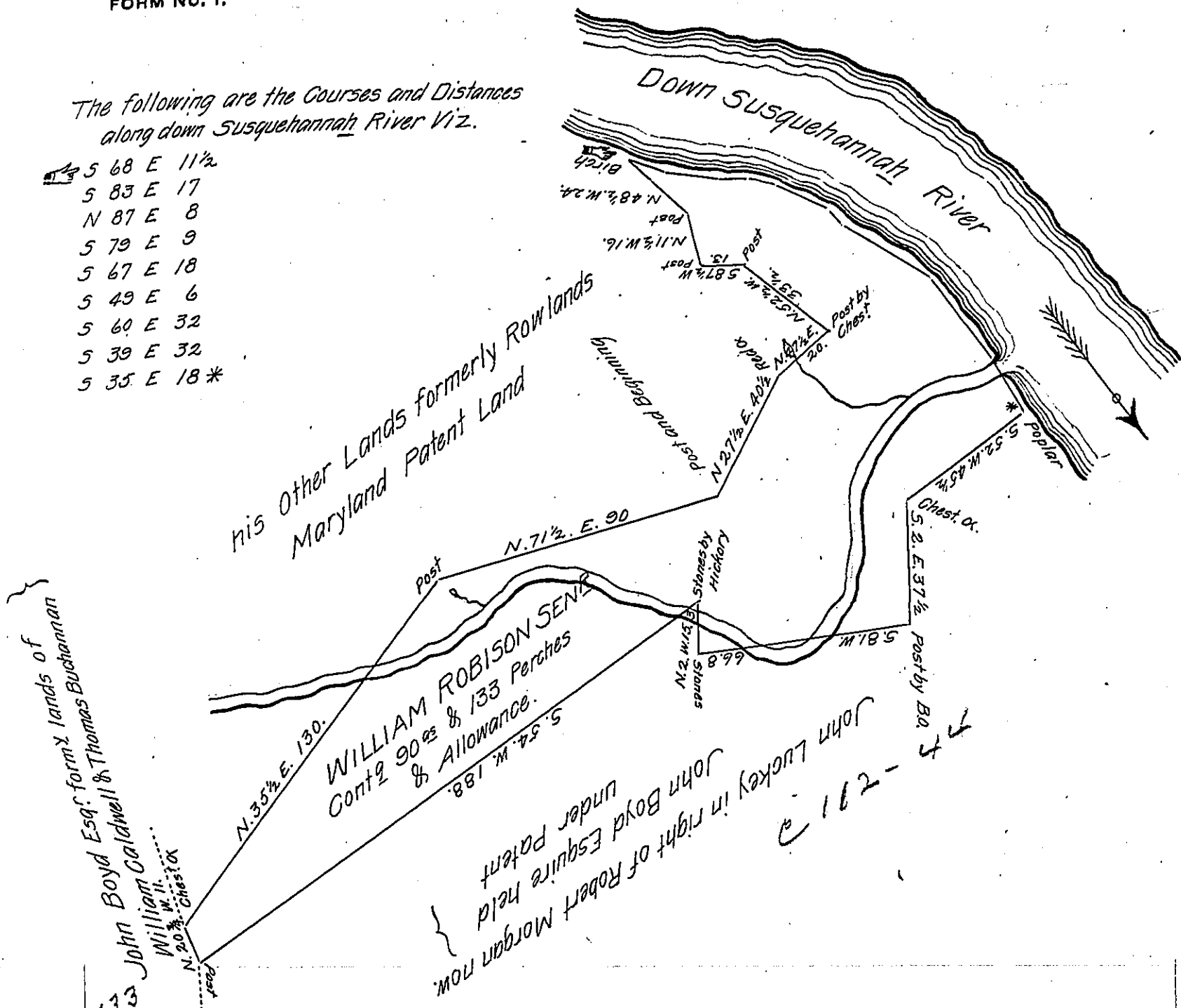

Situate in Fawn Township in the County of York. Containing as above set forth Ninety Acres & one hundred and thirty three Perches & Allowance, Surveyed the 30<sup>th</sup> day of October Anno Domini 1805. In Pursuance of a Warrant for 100<sup>ac</sup> Granted to William Robison<sup>Senr</sup> dated the 18<sup>th</sup> day of October Anno Domini 1804.

Per Jacob Spangler D.S.

To Samuel Cochran Esq  
 Surveyor General  
 Lancaster Pa

John Eichelberger D.S.

IN TESTIMONY that the above is a copy of the original remaining on file in the Department of Internal Affairs of Pennsylvania, made conformably to an Act of Assembly approved the 16th day of February, 1833, I have hereunto set my Hand and caused the Seal of said Department to be affixed at Harrisburg, this twentysixth day of September 1906.

*Loac B. Brown*  
 Secretary of Internal Affairs